

# XB5FK123B5

Harmony XB5, Illuminated selector switch flush mounted, plastic, green, Ø30, 2 positions, stay put, 24 V AC/DC, 1 NO + 1 NC



## Main

|                               |  |
|-------------------------------|--|
| Range of product              | Harmony XB5  |
| Product or component type     | Illuminated selector switch  |
| Device short name             | XB5F   |
| Bezel material                | Dark grey plastic  |
| Head type                     | Built-in-flush   |
| Mounting diameter             | 30.5 mm  |
| Sale per indivisible quantity | 1  |
| Shape of signaling unit head  | Round  |
| Type of operator              | Stay put   |
| Operator profile              | Green standard handle, unmarked  |
| Operator position information | 2 positions 90°  |
| Contacts type and composition | 1 NO + 1 NC  |
| Contact operation             | Slow-break   |
| Connections - terminals       | Screw clamp terminals, <= 2 x 1.5 mm <sup>2</sup> with cable end conforming to EN/IEC 60947-1<br>Screw clamp terminals, >= 1 x 0.22 mm <sup>2</sup> without cable end conforming to EN/IEC 60947-1 |
| Bulb base                     | Integral LED   |
| [Us] rated supply voltage     | 24 V AC/DC at 50/60 Hz   |

## Complementary

|   |   |
|---|---|
| Height                                      | 42 mm   |
| Width                                       | 36.6 mm   |
| Depth                                       | 71 mm   |
| Terminals description ISO n°1               | (21-22)NC<br>(13-14)NO  |
| Resistance to high pressure washer          | 7000000 Pa at 55 °C, distance : 0.1 m   |
| Contacts usage                              | Standard contacts   |
| Positive opening                            | With NC contact conforming to EN/IEC 60947-5-1 appendix K   |
| Mechanical durability                       | 1000000 cycles  |
| Tightening torque                           | 0.8...1.2 N.m conforming to EN 60947-1  |
| Shape of screw head                         | Cross compatible with Philips no 1 screwdriver<br>Cross compatible with pozidriv No 1 screwdriver<br>Slotted compatible with flat Ø 4 mm screwdriver<br>Slotted compatible with flat Ø 5.5 mm screwdriver |
| Contacts material                           | Silver alloy (Ag/Ni)  |
| Short-circuit protection                    | 10 A cartridge fuse type gG conforming to EN/IEC 60947-5-1  |
| [Ith] conventional free air thermal current | 10 A conforming to EN/IEC 60947-5-1   |
| [Ui] rated insulation voltage               | 600 V (pollution degree 3) conforming to EN 60947-1   |
| [Uimp] rated impulse withstand voltage      | EN 60947-1 6 kV   |

The information provided in this documentation contains general descriptions and/or technical characteristics of the performance of the products contained herein. This documentation is not intended as a substitute for and is not to be used for determining suitability or reliability of these products for specific user applications. It is the duty of any such user or integrator to perform the appropriate and complete risk analysis, evaluation and testing of the products with respect to the relevant specific application or use thereof. Neither Schneider Electric Industries SAS nor any of its affiliates or subsidiaries shall be responsible or liable for misuse of the information contained herein.

|   |   |
|---|---|
| [I <sub>e</sub> ] rated operational current | 3 A at 240 V, AC-15, A600 conforming to EN/IEC 60947-5-1<br>6 A at 120 V, AC-15, A600 conforming to EN/IEC 60947-5-1<br>0.1 A at 600 V, DC-13, Q600 conforming to EN/IEC 60947-5-1<br>0.27 A at 250 V, DC-13, Q600 conforming to EN/IEC 60947-5-1<br>0.55 A at 125 V, DC-13, Q600 conforming to EN/IEC 60947-5-1<br>1.2 A at 600 V, AC-15, A600 conforming to EN/IEC 60947-5-1  |
| Electrical durability                       | 1000000 Cycles, AC-15, 2 A at 230 V, operating rate <3600 cyc/h, load factor: 0.5 conforming to EN/IEC 60947-5-1 appendix C<br>1000000 Cycles, AC-15, 3 A at 120 V, operating rate <3600 cyc/h, load factor: 0.5 conforming to EN/IEC 60947-5-1 appendix C<br>1000000 Cycles, AC-15, 4 A at 24 V, operating rate <3600 cyc/h, load factor: 0.5 conforming to EN/IEC 60947-5-1 appendix C<br>1000000 Cycles, DC-13, 0.2 A at 110 V, operating rate <3600 cyc/h, load factor: 0.5 conforming to EN/IEC 60947-5-1 appendix C<br>1000000 cycles, DC-13, 0.5 A at 24 V, operating rate <3600 cyc/h, load factor: 0.5 conforming to EN/IEC 60947-5-1 appendix C |
| Electrical reliability                      | $\Lambda < 10\exp(-6)$ at 5 V and 1 mA in clean environment conforming to EN/IEC 60947-5-4<br>$\Lambda < 10\exp(-8)$ at 17 V and 5 mA in clean environment conforming to EN/IEC 60947-5-4   |
| Light source                                | Protected LED   |
| Supply voltage limits                       | 19.2...30 V DC<br>21.6...26.4 V AC  |
| Device presentation                         | Complete product  |

## Environment

|                                       |  |
|---------------------------------------|--|
| Protective treatment                  | TH   |
| Ambient air temperature for storage   | -40...70 °C  |
| Ambient air temperature for operation | -40...70 °C  |
| Electrical shock protection class     | Class II conforming to IEC 60536   |
| IP degree of protection               | IP66 conforming to IEC 60529<br>IP67<br>IP69<br>IP69K  |
| NEMA degree of protection             | NEMA 13<br>NEMA 4X   |
| IK degree of protection               | IK03 conforming to IEC 50102   |
| Standards                             | EN/IEC 60947-1<br>UL 508<br>JIS C8201-5-1<br>EN/IEC 60947-5-4<br>EN/IEC 60947-5-1<br>CSA C22.2 No 14<br>JIS C8201-1  |
| Product certifications                | UL listed<br>CSA   |
| Vibration resistance                  | 5 gn (f= 2...500 Hz) conforming to IEC 60068-2-6   |
| Shock resistance                      | 30 gn (duration = 18 ms) for half sine wave acceleration conforming to IEC 60068-2-27<br>50 gn (duration = 11 ms) for half sine wave acceleration conforming to IEC 60068-2-27 |

## Packing Units

|                              |        |
|------------------------------|--------|
| Unit Type of Package 1       | PCE    |
| Number of Units in Package 1 | 1      |
| Package 1 Weight             | 57 g   |
| Package 1 Height             | 4.3 cm |
| Package 1 width              | 5.3 cm |
| Package 1 Length             | 8.6 cm |

## Offer Sustainability

|                            |   |
|----------------------------|---|
| Sustainable offer status   | Green Premium product   |
| REACH Regulation           | <a href="#">REACH Declaration</a>   |
| REACH free of SVHC         | Yes   |
| EU RoHS Directive          | Pro-active compliance (Product out of EU RoHS legal scope) <a href="#">EU RoHS Declaration</a>                              |
| Mercury free               | Yes   |
| RoHS exemption information | <a href="#">Yes</a>   |
| China RoHS Regulation      | <a href="#">China RoHS Declaration</a>  |
| Environmental Disclosure   | <a href="#">Product Environmental Profile</a>   |
| Circularity Profile        | <a href="#">End Of Life Information</a>   |
| WEEE                       | The product must be disposed on European Union markets following specific waste collection and never end up in rubbish bins |

## Contractual warranty

|          |           |
|----------|-----------|
| Warranty | 18 months |
|----------|-----------|

Dimensions

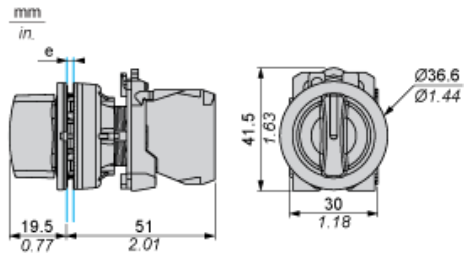

e: Clamping thickness: 1 to 6 mm / 0.04 to 0.24 in.

Panel Cut-out for Pushbuttons, Switches and Pilot Lights (Finished Holes, Ready for Installation)

Connection by Screw Clamp Terminals or Plug-in Connectors

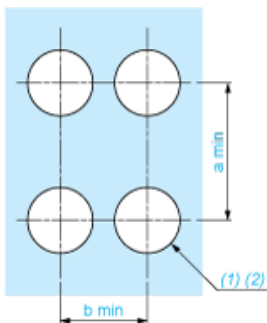

(1) Diameter on finished panel or support

(2)  $\text{Ø}30.75 \text{ mm}$  recommended ( $\text{Ø}30.5 \text{ }_0^{+0.5}$ ) /  $\text{Ø}1.21 \text{ in.}$  recommended ( $\text{Ø}1.20 \text{ in. }_0^{+0.0196}$ )

| Connections                                   | a in mm | a in in. | b in mm | b in in. |
|---|---------|----------|---------|----------|
| By screw clamp terminals or plug-in connector | 40      | 1.57     | 40      | 1.57     |
| By Faston connectors                          | 45      | 1.77     | 40      | 1.57     |

---

Electrical Composition Corresponding to Code M3

---

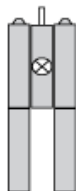

---

Electrical Composition Corresponding to Code M4

---

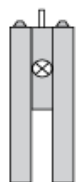

---

Electrical Composition Corresponding to Codes M6 and P2

---

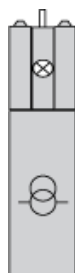

---

Electrical Composition Corresponding to Codes M5, M10, MF1, MR1 and MF2

---

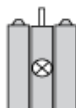

---

Legend

---

Single contact



Double contact



Light block



Possible location



### Sequence of Contacts Fitted to 2-position Selector Switch Body

#### Position 315°



|          |          |        |        |      |  |
|----------|----------|--------|--------|------|--|
| Push     | Position | Top    |        |      |  |
| Bottom   |          |        |        |      |  |
| Location |          | Left   | Right  |      |  |
| State    |          | 0      | 0      |      |  |
| Contacts | N/O      |        | open   | open |  |
| N/C      |          | closed | closed |      |  |

#### Position 45°



|          |          |      |        |        |  |
|----------|----------|------|--------|--------|--|
| Push     | Position | Top  |        |        |  |
| Bottom   |          |      |        |        |  |
| Location |          | Left | Right  |        |  |
| State    |          | 1    | 1      |        |  |
| Contacts | N/O      |      | closed | closed |  |
| N/C      |          | open | open   |        |  |